

Spec / Additional Data Sheet

SKA - Metric Male Weld-on Stand Pipe

SKA

Weld Nipple
24° Flareless / ISO 8434-4 Butt Weld

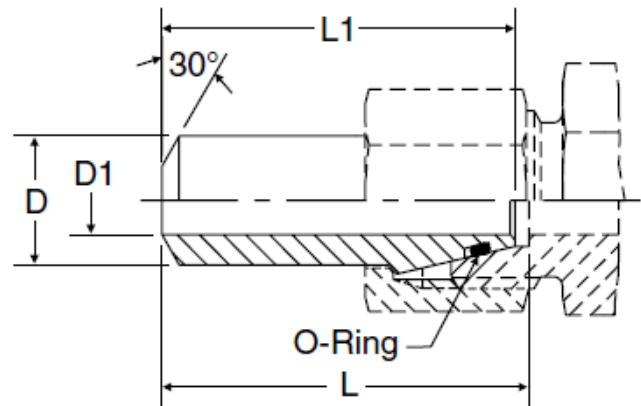

TUBE FITTING PART #	Tube Seamless Steel St. 35.4 NBK	D (mm)	D1 (mm)	L (mm)	L1 (mm)	O-Ring I.D. & Cross Section (mm)
SKA10X1	10 x 1	10	8	33.5	32.5	8 x 1.5
SKA10X1.5	10 x 1.5		7			
SKA10X2	10 x 2		6			
SKA12X1.5	12 x 1.5	12	9	33.5	32.5	10 x 1.5
SKA12X2	12 x 2		8			
SKA12X2.5	12 x 2.5		7			
SKA16X1.5	16 x 1.5	16	13	40.5	39.0	13 x 2
SKA16X2	16 x 2		12			
SKA16X2.5	16 x 2.5		11			
SKA16X3	16 x 3		10			
SKA20X2	20 x 2	20	16	47.0	45.0	16.3 x 2.4
SKA20X2.5	20 x 2.5		15			
SKA20X3	20 x 3		14			
SKA20X4	20 x 4		12			
SKA25X3	25 x 3	25	19	53.0	49.5	20.3 x 2.4
SKA25X4	25 x 4		17			
SKA25X5	25 x 5		15			
SKA30X3	30 x 3	30	24	57.0	52.0	25.3 x 2.4
SKA30X4	30 x 4		22			
SKA30X5	30 x 5		20			
SKA30X6	30 x 6		18			
SKA38X4	38 x 4	38	30	64.0	56.5	33.3 x 2.4
SKA38X5	38 x 5		28			
SKA38X6	38 x 6		26			
SKA38X7	38 x 7		24			

Welding nipple

24° with seal (NBR)/weld

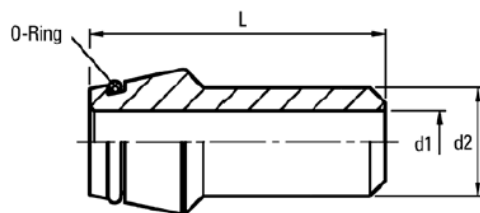

Tube O.D. d2	Bar (psi)	Part Number	d1	L	O-Ring
8	400 (5801)	WAL028783 [†]	4	31,0	6,0 x 1,5
10	315 (4569)	WAL028784 [†]	6	32,5	7,5 x 1,5
12	400 (5801)	WAL028785	7	32,5	9,0 x 1,5
16	400 (5801)	WAL028788	10	38,5	12,0 x 2,0
20	250 (3626)	WAL028790	14	44,5	16,3 x 2,4
	400 (5801)	WAL068737	12		
25	250 (3626)	WAL028792	19	49,5	20,3 x 2,4
	315 (4569)	WAL028793	17		
30	250 (3626)	WAL028795	22	52,0	25,3 x 2,4
	315 (4569)	WAL028796 [†]	20		
	400 (5801)	WAL604551 [†]	18		
38	160 (2321)	WAL028797	30	56,5	33,3 x 2,4
	250 (3626)	WAL028798	28		
	315 (4569)	WAL028799 [†]	26		
	400 (5801)	WAL604552 [†]	24		

O-ring to be fitted after welding.