

Spec / Additional Data Sheet

RI - Metric BSP Male ED x BSP Female Reducer

RI-ED

BSPF Reducing Adapter / Expander
BSPF / BSPF-ED
(for ISO 1179-1 / DIN 3852-2 Port)

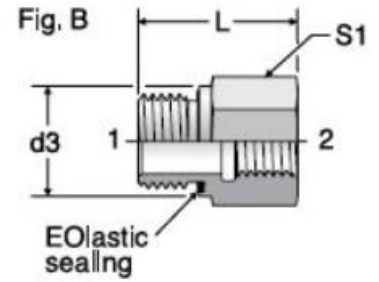
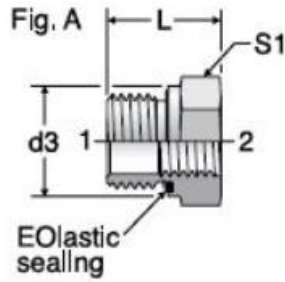

TUBE FITTING PART #	END SIZE		d3 (mm)	L (mm)	S1 (mm)	Fig.	Dynamic Pressure (x 1,000 PSI)		
	1	2					CF	71	MS
	BSPF	BSPF							
RI1/8EDX1/4	1/8 - 28	1/4 - 19	14	31.0	19	B	5.8	5.8	3.3
RI1/8EDX3/8	1/8 - 28	3/8 - 19	14	32.0	24	B	5.8	5.8	3.3
RI1/4EDX1/8	1/4 - 19	1/8 - 28	19	29.0	19	B	5.8	5.8	3.3
RI1/4EDX3/8	1/4 - 19	3/8 - 19	19	36.0	24	B	5.8	5.8	3.3
RI1/4EDX1/2	1/4 - 19	1/2 - 14	19	40.0	30	B	5.8	5.8	3.3
RI1/4EDX3/4	1/4 - 19	3/4 - 14	19	43.0	36	B	5.8	5.8	3.3
RI3/8EDX1/8	3/8 - 19	1/8 - 28	22	22.5	22	A	5.8	5.8	3.3
RI3/8EDX1/4	3/8 - 19	1/4 - 19	22	36.0	22	B	5.8	5.8	3.3
RI3/8EDX1/2	3/8 - 19	1/2 - 14	22	41.0	30	B	5.8	5.8	3.3
RI3/8EDX3/4	3/8 - 19	3/4 - 14	22	44.0	36	B	4.5	4.5	3.0
RI1/2EDX1/8	1/2 - 14	1/8 - 28	27	24.0	27	A	5.8	5.8	3.3
RI1/2EDX1/4	1/2 - 14	1/4 - 19	27	24.0	27	A	5.8	5.8	3.3
RI1/2EDX3/8	1/2 - 14	3/8 - 19	27	37.0	27	B	5.8	5.8	3.3
RI1/2EDX3/4	1/2 - 14	3/4 - 14	27	46.0	36	B	4.5	4.5	3.0
RI1/2EDX1	1/2 - 14	1 - 11	27	49.0	41	B	4.5	4.5	3.0
RI1/2EDX11/4	1/2 - 14	1 1/4 - 11	27	53.0	55	B	4.5	4.5	3.0
RI3/4EDX1/4	3/4 - 14	1/4 - 19	32	26.0	32	A	4.5	4.5	3.0
RI3/4EDX3/8	3/4 - 14	3/8 - 19	32	26.0	32	A	4.5	4.5	3.0
RI3/4EDX1/2	3/4 - 14	1/2 - 14	32	43.0	32	B	4.5	4.5	3.0
RI3/4EDX1	3/4 - 14	1 - 11	32	51.0	41	B	4.5	4.5	3.0
RI3/4EDX11/4	3/4 - 14	1 1/4 - 11	32	55.0	55	B	4.5	4.5	3.0
RI3/4EDX11/2	3/4 - 14	1 1/2 - 11	32	57.0	60	B	3.6	3.6	2.3
RI1EDX1/4	1 - 11	1/4 - 19	40	29.0	41	A	4.5	4.5	3.0
RI1EDX3/8	1 - 11	3/8 - 19	40	29.0	41	A	4.5	4.5	3.0
RI1EDX1/2	1 - 11	1/2 - 14	40	29.0	41	A	4.5	4.5	3.0
RI1EDX3/4	1 - 11	3/4 - 14	40	49.0	41	B	4.5	4.5	3.0
RI1EDX11/4	1 - 11	1 1/4 - 11	40	57.0	55	B	4.5	4.5	3.0
RI1EDX11/2	1 - 11	1 1/2 - 11	40	59.0	60	B	3.6	3.6	2.3
RI11/4EDX1/2	1 1/4 - 11	1/2 - 14	50	32.0	50	A	4.5	4.5	3.0
RI11/4EDX3/4	1 1/4 - 11	3/4 - 14	50	32.0	50	A	4.5	4.5	3.0
RI11/4EDX1	1 1/4 - 11	1 - 11	50	53.0	50	B	4.5	4.5	3.0
RI11/4EDX11/2	1 1/4 - 11	1 1/2 - 11	50	60.0	60	B	3.6	3.6	2.3
RI11/2EDX1/2	1 1/2 - 11	1/2 - 14	55	36.0	55	A	3.6	3.6	2.3
RI11/2EDX3/4	1 1/2 - 11	3/4 - 14	55	36.0	55	A	3.6	3.6	2.3
RI11/2EDX1	1 1/2 - 11	1 - 11	55	36.0	55	A	3.6	3.6	2.3
RI11/2EDX11/4	1 1/2 - 11	1 1/4 - 11	55	58.0	55	B	3.6	3.6	2.3
RI2EDX11/2	2 - 11	1 1/2 - 11	72	65.0	75	B	2.3	2.3	1.5

BSPP Reducer (Short) BSPP male/BSPP female

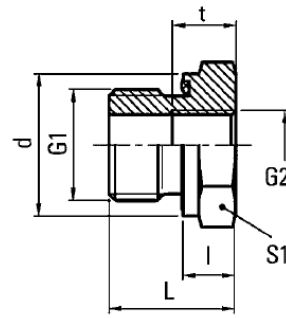

Bar (psi)	DIN-ISO 228 (R..., DIN 259)		Part Number	L	l	d	t	S1
	G1	G2						
630 (9137)	G 3/8 A	G 1/8	WAL606600	22,5	10,5	21,9	8	22
		G 1/2 A	WAL606601	24,0	10,0	26,9	8	27
		G 1/4	WAL606602	24,0	10,0	26,9	12	27
400 (5801)	G 3/4 A	G 1/4	WAL606603	26,0	10,0	31,9	12	32
		G 3/8	WAL606604	26,0	10,0	31,9	12	32
		G 1/4 A	WAL606605	29,0	11,0	39,9	12	41
	G 1 A	G 1/4	WAL606606	29,0	11,0	39,9	12	41
		G 3/8	WAL606607	29,0	11,0	39,9	14	41
		G 1/2	WAL606608	32,0	12,0	49,9	14	50
	G 1 1/4 A	G 1/2	WAL606609	32,0	12,0	49,9	16	50
		G 3/4	WAL606610	36,0	14,0	54,9	14	55
	G 1 1/2 A	G 1/2	WAL606611	36,0	14,0	54,9	16	55
		G 3/4	WAL606612	36,0	14,0	54,9	18	55

BSPP Reducer (long) BSPP male/BSPP female

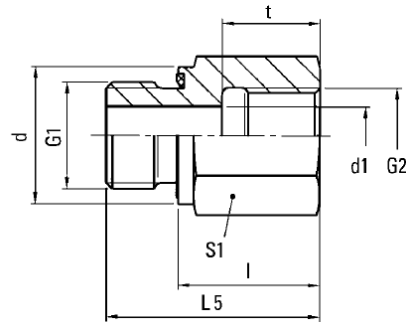

Bar (psi)	G1	G2	Part Number	L5	l	d	d1	t	S1
400 (5801)	G 1/8 A	G 1/4	WAL606613	31	23	13,9	4	17,0	19
		G 3/8	WAL606614	32	24	13,9	4	17,0	24
	G 1/4 A	G 1/8	WAL606615	29	17	18,9	5	12,0	19
		G 3/8	WAL606616	36	24	18,9	5	17,0	24
		G 1/2	WAL606617	40	28	18,9	5	20,0	30
	G 3/8 A	G 3/4	WAL606618	43	31	18,9	5	22,0	36
		G 1/4	WAL606619	36	24	21,9	8	17,0	22
		G 1/2	WAL606620	41	29	21,9	8	20,0	30
	G 1/2 A	G 3/4	WAL606621	44	32	21,9	8	22,0	36
		G 3/8	WAL606622	37	23	26,9	12	17,0	27
		G 3/4	WAL606623	46	32	26,9	12	22,0	36
		G 1	WAL606624	49	35	26,9	12	24,5	41
250 (3626)	G 1/2 A	G 1 1/4	WAL606625†	53	39	26,9	12	26,5	55
400 (5801)		G 3/4 A	WAL606626	43	27	31,9	16	20,0	32
		G 1	WAL606627	51	35	31,9	16	24,5	41
250 (3626)	G 3/4 A	G 1 1/4	WAL606628	55	39	31,9	16	26,5	55
		G 1 1/2	WAL606629	57	41	31,9	16	28,5	60
400 (5801)	G 1 A	G 3/4	WAL606630	49	31	39,9	20	22,0	41
250 (3626)		G 1 1/4	WAL606631	57	39	39,9	20	26,5	55
		G 1 1/2	WAL606632	59	41	39,9	20	28,5	60
400 (5801)	G 1 1/4 A	G 1	WAL606633	53	33	49,9	25	24,5	50
250 (3626)	G 1 1/4 A	G 1 1/2	WAL606634	60	40	49,9	25	28,5	60
	G 1 1/2 A	G 1 1/4	WAL606635	58	36	54,9	32	26,5	55