

Swivel-Branch-Tee AGJ - DKJ - AGJ

Pressure	Tube O.D.		Thread	Approx. Dimensions					
	PN	mm		in.	G	L	L2	D	SW1
350		6	1/4"	7/16"-20 UNF	22,5	16,7	4,0	16	11
350		8	5/16"	1/2"-20 UNF	24,0	17,5	5,5	17	13
350		10	3/8"	9/16"-18 UNF	27,0	22,3	7,5	19	14
350		12	1/2"	3/4"-16 UNF	31,0	24,5	10,0	24	19
350		14, 15, 16	5/8"	7/8"-14 UNF	37,5	29,5	12,0	27	24
350		18, 20	3/4"	1 1/16"-12 UN	42,0	31,0	15,5	32	24
250		25	1"	1 5/16"-12 UN	46,0	35,7	21,5	41	36
210		28, 30, 32	1 1/4"	1 5/8"-12 UN	52,5	42,8	27,5	50	41
170		35, 38	1 1/2"	1 7/8"-12 UN	59,0	47,2	33,0	55	50
150		50	2"	2 1/2"-12 UN	77,5	62,1	45,0	70	65

JIC 37° Flare

SAE J514

Originally named for the now-defunct Joint Industrial Commission (JIC), this connection is very common in fluid power systems. Both the male and female halves of this connection have 37° seats. The seal takes place by establishing a line of contact between the male flare and the female cone seat. The threads hold the connection mechanically.

This connection is also commonly used with flared tubing (not pictured).

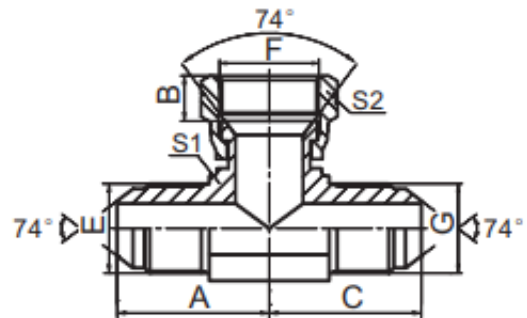
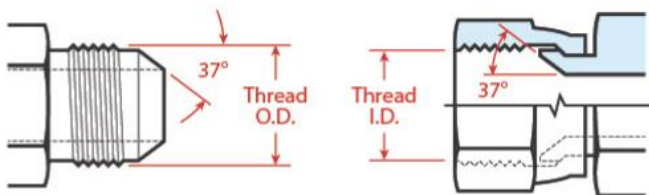

代号 PART NO.	螺纹 THREAD			尺寸 DIMENSIONS				
	E	F	G	A	B	C	S1	S2
BJ-04	7/16"X20	7/16"X20	7/16"X20	24.5	9	24.5	11	15
BJ-05	1/2"X20	1/2"X20	1/2"X20	26.5	9.5	26.5	14	17
BJ-06	9/16"X18	9/16"X18	9/16"X18	26.9	10.5	26.9	14	19
BJ-08	3/4"X16	3/4"X16	3/4"X16	32	11	32	19	24
BJ-10	7/8"X14	7/8"X14	7/8"X14	37.8	14	37.8	22	27
BJ-12	1.1/16"X12	1.1/16"X12	1.1/16"X12	44.2	15	44.2	27	32
BJ-14	1.3/16"X12	1.3/16"X12	1.3/16"X12	47.5	15	47.5	30	36
BJ-16	1.5/16"X12	1.5/16"X12	1.5/16"X12	49	16	49	33	41
BJ-20	1.5/8"X12	1.5/8"X12	1.5/8"X12	56	17	56	41	50
BJ-24	1.7/8"X12	1.7/8"X12	1.7/8"X12	63.5	20	63.5	48	55
BJ-32	2.1/2"X12	2.1/2"X12	2.1/2"X12	78	24.5	78	63	75

6600 SWIVEL BRANCH TEE

SAE J514 070433

MS51524

Your 1 Stop Source

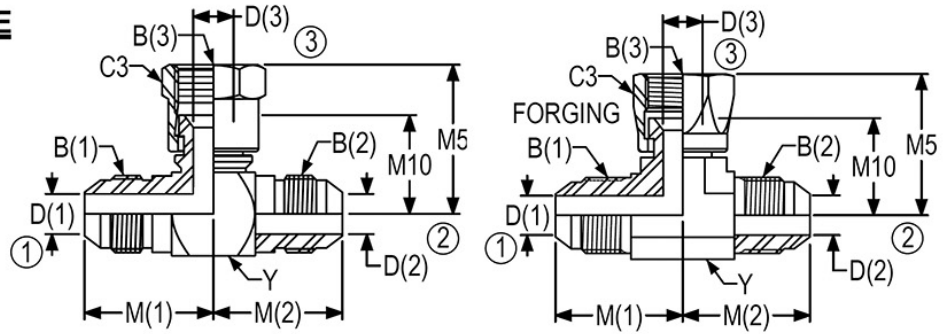

*Non forging parts are brazed construction

PART NO	TUBE OD	B (1) UN/UNF-2A	B (2) UN/UNF-2A	B (3) UN/UNF-2B	M (1)	M (2)	M5	M10
6600-4-4-4	1/4-1/4-1/4	7/16-20	7/16-20	7/16-20	0.89	0.89	1.00	0.66
6600-4-4-4-FG	1/4-1/4-1/4	7/16-20	7/16-20	7/16-20	0.89	0.89	1.00	0.66
6600-5-5-5	5/16-5/16-5/16	1/2-20	1/2-20	1/2-20	0.95	0.95	1.06	0.69
6600-5-5-5-FG	5/16-5/16-5/16	1/2-20	1/2-20	1/2-20	0.95	0.95	1.06	0.69
6600-6-6-6	3/8-3/8-3/8	9/16-18	9/16-18	9/16-18	1.06	1.06	1.25	0.88
6600-6-6-6-FG	3/8-3/8-3/8	9/16-18	9/16-18	9/16-18	1.06	1.06	1.25	0.88
6600-6-6-8	3/8-3/8-1/2	9/16-18	9/16-18	3/4-16	1.16	1.16	1.38	0.96
6600-8-8-8	1/2-1/2-1/2	3/4-16	3/4-16	3/4-16	1.25	1.25	1.38	0.96
6600-8-8-10	1/2-1/2-5/8	3/4-16	3/4-16	7/8-14	1.31	1.31	1.62	1.12
6600-8-8-12	1/2-1/2-3/4	3/4-16	3/4-16	1 1/16-12	1.40	1.40	1.75	1.19
6600-8-8-16	1/2-1/2-1	3/4-16	3/4-16	1 5/16-12	1.53	1.53	2.02	1.43
6600-10-8-10	5/8-1/2-5/8	7/8-14	3/4-16	7/8-14	1.45	1.31	1.62	1.12
6600-10-10-10	5/8-5/8-5/8	7/8-14	7/8-14	7/8-14	1.45	1.45	1.62	1.12
6600-10-10-10-FG	5/8-5/8-5/8	7/8-14	7/8-14	7/8-14	1.45	1.45	1.62	1.12
6600-12-12-10	3/4-3/4-5/8	1 1/16-12	1 1/16-12	7/8-14	1.66	1.66	1.71	1.21
6600-12-12-12	3/4-3/4-3/4	1 1/16-12	1 1/16-12	1 1/16-12	1.66	1.66	1.75	1.19
6600-12-12-12-FG	3/4-3/4-3/4	1 1/16-12	1 1/16-12	1 1/16-12	1.66	1.66	1.75	1.19
6600-12-12-16	3/4-3/4-1	1 1/16-12	1 1/16-12	1 5/16-12	1.78	1.78	2.02	1.43
6600-14-14-14	7/8-7/8-7/8	1 3/16-12	1 3/16-12	1 3/16-12	1.80	1.80	1.78	1.22
6600-16-12-12	1-3/4-3/4	1 5/16-12	1 1/16-12	1 1/16-12	1.81	1.78	1.88	1.31
6600-16-12-16	1-3/4-1	1 5/16-12	1 1/16-12	1 5/16-12	1.81	1.78	2.00	1.41
6600-16-16-8	1-1-1/2	1 5/16-12	1 5/16-12	3/4-16	1.81	1.81	1.66	1.24
6600-16-16-16	1-1-1	1 5/16-12	1 5/16-12	1 5/16-12	1.81	1.81	2.00	1.41
6600-16-16-16-FG	1-1-1	1 5/16-12	1 5/16-12	1 5/16-12	1.81	1.81	2.00	1.41
6600-20-12-16	1 1/4-3/4-1	1 5/8-12	1 1/16-12	1 5/16-12	2.06	1.97	2.21	1.62
6600-20-20-20	1 1/4-1 1/4-1 1/4	1 5/8-12	1 5/8-12	1 5/8-12	2.06	2.06	2.31	1.68
6600-20-20-20-FG	1 1/4-1 1/4-1 1/4	1 5/8-12	1 5/8-12	1 5/8-12	2.06	2.06	2.31	1.69
6600-24-24-24	1 1/2-1 1/2-1 1/2	1 7/8-12	1 7/8-12	1 7/8-12	2.33	2.33	2.59	1.86
6600-24-24-24-FG	1 1/2-1 1/2-1 1/2	1 7/8-12	1 7/8-12	1 7/8-12	2.33	2.33	2.59	1.86
6600-32-32-32	2-2-2	2 1/2-12	2 1/2-12	2 1/2-12	3.06	3.06	3.38	2.44
6600-32-32-32-FG	2-2-2	2 1/2-12	2 1/2-12	2 1/2-12	3.06	3.06	3.38	2.44