

# MCJB

## JIC MALE x BSP MALE - STRAIGHT



Part No.	Size	
	JIC	BSP
<b>MCJB-04-02</b>	7/16	1/8
<b>MCJB-04-04</b>	7/16	1/4
<b>MCJB-04-06</b>	7/16	3/8
<b>MCJB-04-08</b>	7/16	1/2
<b>MCJB-05-04</b>	1/2	1/4
<b>MCJB-06-04</b>	9/16	1/4
<b>MCJB-06-06</b>	9/16	3/8
<b>MCJB-06-08</b>	9/16	1/2
<b>MCJB-06-10</b>	9/16	5/8
<b>MCJB-06-12</b>	9/16	3/4
<b>MCJB-08-04</b>	3/4	1/4
<b>MCJB-08-06</b>	3/4	3/8
<b>MCJB-08-08</b>	3/4	1/2
<b>MCJB-08-10</b>	3/4	5/8
<b>MCJB-08-12</b>	3/4	3/4
<b>MCJB-08-16</b>	3/4	1
<b>MCJB-10-06</b>	7/8	3/8
<b>MCJB-10-08</b>	7/8	1/2
<b>MCJB-10-10</b>	7/8	5/8
<b>MCJB-10-12</b>	7/8	3/4
<b>MCJB-12-08</b>	1 1/16	1/2
<b>MCJB-12-10</b>	1 1/16	5/8
<b>MCJB-12-12</b>	1 1/16	3/4
<b>MCJB-12-16</b>	1 1/16	1
<b>MCJB-12-20</b>	1 1/16	1 1/4
<b>MCJB-16-12</b>	1 5/16	3/4
<b>MCJB-16-16</b>	1 5/16	1
<b>MCJB-16-20</b>	1 5/16	1 1/4
<b>MCJB-16-24</b>	1 5/16	1 1/2
<b>MCJB-20-16</b>	1 5/8	1
<b>MCJB-20-20</b>	1 5/8	1 1/4
<b>MCJB-20-24</b>	1 5/8	1 1/2
<b>MCJB-24-20</b>	1 7/8	1 1/4
<b>MCJB-24-24</b>	1 7/8	1 1/2
<b>MCJB-32-32</b>	2 1/2	2

BSP MALE DOUBLE USE FOR 60° CONE SEAT  
OR BONDED SEAL / JIC MALE 74° CONE

1BJ

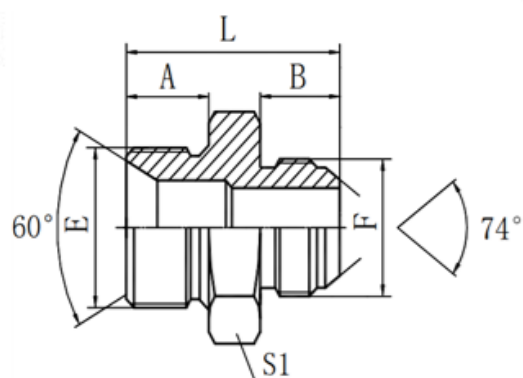

代号 PART NO.	螺纹 THREAD		尺寸 DIMENSIONS				
	E	F	A	B	L	S1	
1BJ-02-04	G1/8"X28	7/16"X20	10	14	30	14	
1BJ-02-05	G1/8"X28	1/2"X20	10	14	30	14	
1BJ-02-06	G1/8"X28	9/16"X18	10	14.1	30	17	
1BJ-04	G1/4"X19	7/16"X20	12	14	32	19	
1B4-04-05	G1/4"X19	1/2"X20	12	14	32	19	
1B4-04-06	G1/4"X19	9/16"X18	12	14.1	32	19	
1BJ-04-08	G1/4"X19	3/4"X16	12	16.7	36.5	22	
1BJ-04-10	G1/4"X19	7/8"X14	12	19.3	39	24	
1BJ-06	G3/8"X19	9/16"X18	13.5	14.1	35.5	22	
1BJ-06-04	G3/8"X19	7/16"X20	13.5	14	35.5	22	
1BJ-06-05	G3/8"X19	1/2"X20	13.5	14	35.5	22	
1BJ-06-08	G3/8"X19	3/4"X16	13.5	16.7	38.5	22	
1BJ-06-10	G3/8"X19	7/8"X14	13.5	19.3	41	24	
1BJ-06-12	G3/8"X19	1.1/16"X12	13.5	21.9	45	30	
1BJ-08	G1/2"X14	3/4"X16	16	16.7	43	27	
1BJ-08-04	G1/2"X14	7/16"X20	16	14	40	27	
1BJ-08-05	G1/2"X14	1/2"X20	16	14	40	27	
1BJ-08-06	G1/2"X14	9/16"X18	16	14.1	40	27	
1BJ-08-10	G1/2"X14	7/8"X14	16	19.3	45.5	27	
1BJ-08-12	G1/2"X14	1.1/16"X12	16	21.9	48	30	
1BJ-08-14	G1/2"X14	1.3/16"X12	16	22.6	49.5	32	
1BJ-08-16	G1/2"X14	1.5/16"X12	16	23.1	50	36	
1BJ-10	G5/8"X14	7/8"X14	17.5	19.3	47	30	
1BJ-10-08	G5/8"X14	3/4"X16	17.5	16.7	44	30	
1BJ-10-12	G5/8"X14	1.1/16"X12	17.5	21.9	49.5	30	
1BJ-10-16	G5/8"X14	1.5/16"X12	17.5	23.1	51.5	36	
1BJ-12	G3/4"X14	1.1/16"X12	18.5	21.9	51.5	32	