

Description:
Part No.:

**MALE SAE TO FEMALE PIPE SWIVEL STRAIGHT
6900**

Parker:
Weatherhead:
Aeroquip:
Gates:

507
9315
2066-[R]
MB-FPX

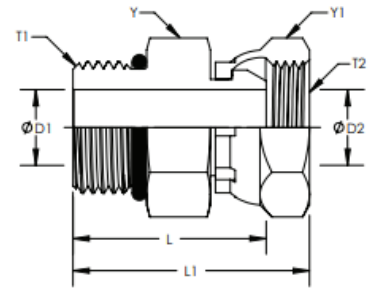

Item #	Y Hex	Y1 Hex	T1	D1	T2	D2	L	L1
9-6900-4-4	0.563	0.688	7/16-20	0.172	1/4-18	0.220	1.110	1.300
9-6900-5-4	0.625	0.688	1/2-20	0.234	1/4-18	0.220	1.090	1.250
9-6900-6-4	0.688	0.688	9/16-18	0.297	1/4-18	0.220	1.070	1.260
9-6900-6-6	0.875	0.875	9/16-18	0.297	3/8-18	0.340	1.250	1.460
9-6900-6-8	0.813	1.000	9/16-18	0.297	1/2-14	0.460	1.290	1.570
9-6900-8-6	0.875	0.875	3/4-16	0.391	3/8-18	0.340	1.190	1.400
9-6900-8-8	0.875	1.000	3/4-16	0.391	1/2-14	0.460	1.270	1.550
9-6900-8-12	1.000	1.250	3/4-16	0.391	3/4-14	0.635	1.410	1.760
9-6900-10-8	1.000	1.000	7/8-14	0.484	1/2-14	0.460	1.330	1.610
9-6900-10-12	1.000	1.250	7/8-14	0.484	3/4-14	0.635	1.370	1.720
9-6900-12-8	1.250	1.000	1-1/16-12	0.609	1/2-14	0.460	1.450	1.730
9-6900-12-12	1.250	1.250	1-1/16-12	0.609	3/4-14	0.635	1.600	1.950
9-6900-12-16	1.250	1.500	1-1/16-12	0.609	1-11-1/2	0.831	1.700	2.050
9-6900-16-12	1.500	1.250	1-5/16-12	0.844	3/4-14	0.635	1.730	2.080
9-6900-16-16	1.500	1.500	1-5/16-12	0.844	1-11-1/2	0.831	1.710	2.060
9-6900-20-16	1.875	1.500	1-5/8-12	1.078	1-11-1/2	0.831	1.790	2.140
9-6900-20-20	1.875	1.875	1-5/8-12	1.078	1-1/4-11-1/2	1.087	1.790	2.210

6900-0

MORB-FPS STRAIGHT

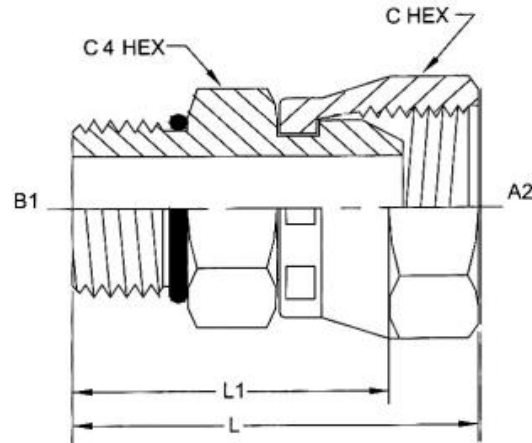

PART NO.	TUBE O.D.	B1 SAE ORB	A2 NPSM	B1 DRILL	A2 DRILL	L1 LGTH	L LGTH	C HEX	C4 HEX
6900-04-04-0	1/4	7/16-20	1/4-18	0.172	0.210	1.110	1.300	0.688	0.562
6900-04-06-0	1/4	7/16-20	3/8-18	0.172	0.340	1.15	1.36	0.875	0.688
6900-06-06-0	3/8	9/16-18	3/8-18	0.297	0.320	1.17	1.46	0.875	0.688
6900-06-08-0	3/8	9/16-18	1/2-14	0.297	0.440	1.290	1.570	1.000	0.812
6900-08-08-0	1/2	3/4-16	1/2-14	0.391	0.460	1.30	1.55	1.000	0.875
6900-12-12-0	3/4	1-1/16-12	3/4-14	0.609	0.609	1.60	1.95	1.250	1.250

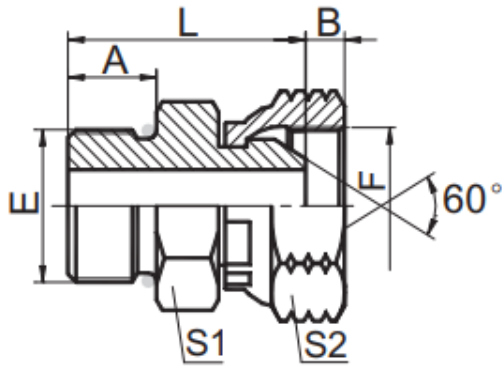

2OU

SAE 外螺纹带 O 形圈轻系列 ISO 11926-3 /
美制 NPSM 内螺纹 60° 外锥
SAE O-RING BOSS L-SERIES ISO
11926-3 / NPSM FEMALE 60° CONE

代号 PART NO.	螺纹 THREAD		O形圈 O-RING		尺寸 DIMENSIONS				
	E	F	E端		A	B	L	S1	S2
2OU-04	7/16"X20	1/4"X18	O904		9.1	4.6	26	14	19
2OU-04-06	7/16"X20	3/8"X18	O904		9.1	6	27.5	17	22
2OU-06	9/16"X18	3/8"X18	O906		9.9	6	28.5	17	22
2OU-06-08	9/16"X18	1/2"X14	O906		9.9	7.5	30	19	27
2OU-08	3/4"X16	1/2"X14	O908		11.1	7.5	33	22	27
2OU-08-06	3/4"X16	3/8"X18	O908		11.1	6	31	22	22
2OU-10-08	7/8"X14	1/2"X14	O910		12.7	7.5	36.5	27	27
2OU-12-08	1.1/16"X12	1/2"X14	O912		15.1	7.5	40	32	27
2OU-12	1.1/16"X12	3/4"X14	O912		15.1	8.9	41	32	32
2OU-12-16	1.1/16"X12	1"X11.5	O912		15.1	10.5	42.5	32	41
2OU-16	1.5/16"X12	1"X11.5	O916		15.1	10.5	42.5	38	41
2OU-20	1.5/8"X12	1.1/4"X11.5	O920		15.1	11.2	50	50	50
2OU-24	1.7/8"X12	1.1/2"X11.5	O924		15.1	11.2	50	55	55