

4MN-WD metric hydraulic male thread plug hydraulic male plug.

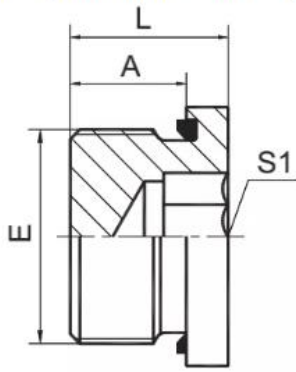

## 4MN-WD

公制外螺纹胶垫密封内六角堵头

代号	螺 纹		胶 垫		尺 寸				
	E		E 端		A	L	S1		
4MN-10WD	M10X1		WD-B02		8	12	5		
4MN-12WD	M12X1.5		WD-M12		12	17	6		
4MN-14WD	M14X1.5		WD-B04		12	17	6		
4MN-16WD	M16X1.5		WD-M16		12	17	8		
4MN-18WD	M18X1.5		WD-M18		12	17	8		
4MN-20WD	M20X1.5		WD-M20		14	19	10		
4MN-22WD	M22X1.5		WD-M22		14	19	10		
4MN-26WD	M26X1.5		WD-B12		16	21	12		
4MN-27WD	M27X2		WD-B12		16	21	12		
4MN-33WD	M33X2		WD-B16		18	24.5	17		
4MN-42WD	M42X2		WD-B20		20	26.5	22		
4MN-48WD	M48X2		WD-B24		22	28.5	24		

## VSTI M-ED

Metric Hollow Hex Plug

Metric-ED

(for ISO 9974-1 / DIN 3852-1 Port)

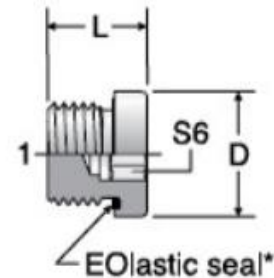

TUBE FITTING PART #	END SIZE		D (mm)	L (mm)	S6 (mm)	Dynamic Pressure (x 1,000 PSI)			
	1 THREAD						CF	71	MS
VSTI10X1ED	M10 x 1		14	12.0	5	5.8	5.8	3.3	
VSTI12X1.5ED	M12 x 1.5		17	17.0	6	5.8	5.8	3.3	
VSTI14X1.5ED	M14 x 1.5		19	17.0	6	5.8	5.8	3.3	
VSTI16X1.5ED	M16 x 1.5		22	17.0	8	5.8	5.8	3.3	
VSTI18X1.5ED	M18 x 1.5		24	17.0	8	5.8	5.8	3.3	
VSTI20X1.5ED	M20 x 1.5		26	19.0	10	5.8	5.8	3.3	
VSTI22X1.5ED	M22 x 1.5		27	19.0	10	5.8	5.8	3.3	
VSTI26X1.5ED	M26 x 1.5		32	21.0	12	5.8	5.8	3.3	
VSTI27X2ED	M27 x 2		32	21	12	5.8	5.8	3.3	
VSTI33X2ED	M33 x 2		40	22.5	17	5.8	5.8	3.3	
VSTI42X2ED	M42 x 2		50	22.5	22	4.5	4.5	2.9	
VSTI48X2ED	M48 x 2		55	22.5	24	4.5	4.5	2.9	