

## Dimensional Drawings:

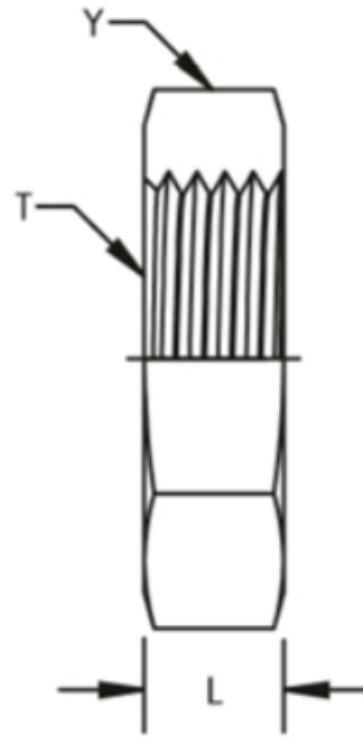

Product ID	Y HEX	T	L
SS-306-02	0.563	5/16-24	0.22
SS-306-03	0.625	3/8-24	0.22
SS-306-04	0.688	7/16-20	0.28
SS-306-05	0.75	1/2-20	0.28
SS-306-06	0.813	9/16-18	0.27
SS-306-08	1	3/4-16	0.31
SS-306-10	1.125	7/8-14	0.36
SS-306-12	1.375	1-1/16-12	0.41
SS-306-14	1.5	1-3/16-12	0.41
SS-306-16	1.625	1-5/16-12	0.41
SS-306-20	1.875	1-5/8-12	0.41
SS-306-24	2.125	1-7/8-12	0.41
SS-306-32	2.75	2-1/2-12	0.41