

### 43 Series Fittings

Use with 301, 301LT, 304, 341, 381, 421, 421HT, 421WC, 424, 431, 436, 451TC, 471, 471ST, 481, 601, 604, and 881 hoses.

Metric L

## 11D43 Male Standpipe Metric L - Rigid Straight

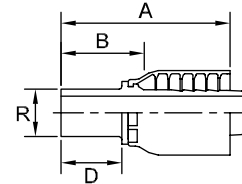

Note: Mates with EO "L" Series Fittings.

# Part Number	R		Hose		A		D		B	
	mm		inch		inch	mm	inch	mm	inch	mm
11D43-6-4	6	-6	1/4	-4	2.03	52	0.87	22	1.28	33
11D43-8-4	8	-8	1/4	-4	2.03	52	0.87	22	1.28	33
11D43-10-5	10	-10	5/16	-5	2.36	60	0.91	23	1.45	37
11D43-10-6	10	-10	3/8	-6	2.28	58	0.91	23	1.14	29
11D43-12-6	12	-12	3/8	-6	2.36	60	0.91	23	1.36	35
11D43-15-8	15	-15	1/2	-8	2.56	65	0.98	25	1.22	31
11D43-18-10	18	-18	5/8	-10	2.99	76	1.02	26	1.48	38
11D43-18-12	18	-18	3/4	-12	2.80	71	1.02	26	1.22	31
11D43-22-12	22	-22	3/4	-12	2.87	73	1.10	28	1.26	32
11D43-28-16	28	-28	1	-16	3.31	84	1.18	30	1.46	37
11D43-42-24+	42	-42	1-1/2	-24	3.50	89	1.40	36	2.18	55

## 1D043 Male Metric L - Rigid Straight (24° Cone)

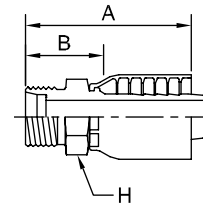

Note: Mates with EO "L" Series Fittings.

# Part Number	Thread			Hose		A		H	B	
	mm			inch		inch	mm	mm	inch	mm
1D043-6-4	6	M12x1,5	-6	1/4	-4	1.73	44	14	0.93	24
1D043-8-4	8	M14x1,5	-8	1/4	-4	1.61	41	14	0.93	24
1D043-10-5	10	M16x1,5	-10	5/16	-5	1.97	50	19	0.83	21
1D043-10-6	10	M16x1,5	-10	3/8	-6	1.97	50	19	0.83	21
1D043-12-6	12	M18x1,5	-12	3/8	-6	1.97	50	19	0.83	21
1D043-15-8	15	M22x1,5	-15	1/2	-8	2.28	58	22	0.94	24
1D043-18-10	18	M26x1,5	-18	5/8	-10	2.68	68	27	1.14	29
1D043-18-12	18	M26x1,5	-18	3/4	-12	2.68	68	27	1.14	29
1D043-22-12	22	M30x2	-22	3/4	-12	2.72	69	30	1.22	31
1D043-28-16	28	M36x2	-28	1	-16	3.11	79	36	1.30	33

+ Non-standard