

43 Series Fittings

Use with 301, 301LT, 304, 341, 381, 421, 421HT, 421WC, 424, 431, 436, 451TC, 471, 471ST, 481, 601, 604, and 881 hoses.

1CA43 Female Metric L - Swivel Straight (24° Cone with O-Ring)

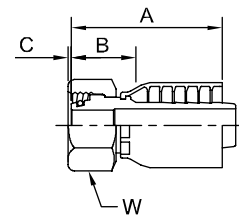

Note: When measuring overall length to the end of the nut, B & C must be used to calculate cut-off allowance.

Note: Mates with EO "L" Series Fittings.

Note: "C" - Stainless Steel Fitting. Must be crimped with Karrykrimp 2, PHastkrimp, Superkrimp, or Parkrimp 2.

# Part Number	Thread			Hose		A		C		W	B	
	mm			inch		inch	mm	inch	mm	mm	inch	mm
	mm	mm	mm	inch	inch	inch	mm	inch	mm	mm	inch	mm
1CA43-6-4	6	M12x1,5	-6	1/4	-4	1.81	46	0.02	1	14	1.06	27
1CA43-8-4	8	M14x1,5	-8	1/4	-4	1.68	43	0.01	0	19	0.88	22
1CA43-10-5	10	M16x1,5	-10	5/16	-5	1.73	44	0.04	1	19	0.82	21
1CA43-12-6	12	M18x1,5	-12	3/8	-6	2.17	55	0.03	1	22	1.02	26
1CA43-15-8	15	M22x1,5	-15	1/2	-8	2.52	64	0.07	2	27	1.14	29
1CA43-18-10	18	M26X1.5	-18	5/8	-10	3.02	77	0.02	1	32	1.61	41
1CA43-18-10C+	18	M26X1.5	-18	5/8	-10	3.02	77	0.02	1	32	1.61	41
1CA43-18-12	18	M26X1.5	-18	3/4	-12	2.56	65	0.02	1	32	1.11	28
1CA43-22-12	22	M30x2	-22	3/4	-12	2.83	72	0.13	3	36	1.30	33
1CA43-28-16	28	M36x2	-28	1	-16	3.35	85	0.14	4	46	1.57	40
1CA43-35-20	35	M45x2	-35	1-1/4	-20	3.28	83	0.00	0	50	1.55	39

1CE43 Female Metric L - Swivel 45° Elbow (24° Cone with O-Ring)

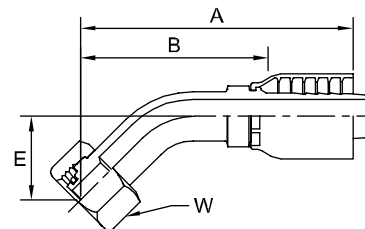

Note: Mates with EO "L" Series Fittings.

# Part Number	Thread			Hose		A		E		W	B	
	mm			inch		inch	mm	inch	mm	mm	inch	mm
	mm	mm	mm	inch	inch	inch	mm	inch	mm	mm	inch	mm
1CE43-10-6	10	M16x1,5	-10	3/8	-6	3.43	87	0.73	19	19	2.44	62
1CE43-12-6	12	M18x1,5	-12	3/8	-6	2.87	73	0.87	22	22	1.73	44
1CE43-15-8	15	M22x1,5	-15	1/2	-8	3.39	86	0.87	22	27	2.00	51
1CE43-22-12	22	M30x2	-22	3/4	-12	3.82	97	0.98	25	36	2.28	58

+ Non-standard