

### 43 Series Fittings

Metric S

Use with 301, 301LT, 304, 341, 381, 421, 421HT, 421WC, 424, 431, 436, 451TC, 471, 471ST, 481, 601, 604, and 881 hoses.

### 1C943 Female Metric S - Swivel Straight (24° Cone with O-Ring)

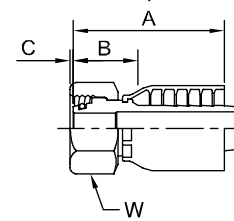

Note: When measuring overall length to the end of the nut, B & C must be used to calculate cut-off allowance.

Note: Mates with EO "S" Series Fittings.

# Part Number	Thread			Hose		A		C		W	B	
	mm			inch		inch	mm	inch	mm	mm	inch	mm
1C943-8-4	8	M16x1,5	-8	1/4	-4	1.64	42	0.01	0	19	1.18	30
1C943-10-4	10	M18x1,5	-10	1/4	-4	1.64	42	0.01	0	22	1.18	30
1C943-10-6	10	M18x1,5	-10	3/8	-6	1.97	50	0.01	0	22	0.83	21
1C943-12-5	12	M20x1,5	-12	5/16	-5	1.80	46	0.03	1	24	0.99	25
1C943-12-6	12	M20x1,5	-12	3/8	-6	1.99	51	0.03	1	24	1.04	26
1C943-14-6	14	M22x1,5	-14	3/8	-6	2.05	52	0.03	1	27	1.17	30
1C943-16-8	16	M24x1,5	-16	1/2	-8	2.33	59	0.09	2	30	1.15	29
1C943-20-10	20	M30x2	-20	5/8	-10	2.59	66	0.05	1	36	1.22	31
1C943-20-12	20	M30x2	-20	3/4	-12	2.59	66	0.05	1	36	1.22	31
1C943-25-12	25	M36x2	-25	3/4	-12	2.67	68	0.10	3	46	1.24	31
1C943-30-16	30	M42x2	-30	1	-16	3.19	81	0.19	5	50	1.60	41
1C943-38-20	38	M52x2	-38	1-1/4	-20	3.35	85	0.23	6	60	1.70	43

### 10C43 Female Metric S - Swivel 45° Elbow (24° Cone with O-Ring)

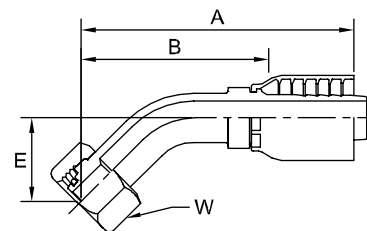

Note: Mates with EO "S" Series Fittings.

# Part Number	Thread			Hose		A		E		W	B	
	mm			inch		inch	mm	inch	mm	mm	inch	mm
10C43-10-4+	10	M18x1.5	-10	1/4	-4	2.85	72	0.71	18	22	2.10	53
10C43-12-6	12	M20x1,5	-12	3/8	-6	3.28	83	0.87	22	24	2.28	58
10C43-14-6+	14	M22x1,5	-14	3/8	-6	3.27	83	0.87	22	27	2.27	58
10C43-16-8	16	M24x1,5	-16	1/2	-8	3.96	101	0.96	24	30	2.71	69
10C43-20-10	20	M30x2	-20	5/8	-10	4.78	121	1.12	28	36	3.37	86
10C43-25-12	25	M36x2	-25	3/4	-12	3.97	101	1.06	27	46	2.40	61
10C43-30-16	30	M42x2	-30	1	-16	4.65	118	1.22	31	50	2.87	73
10C43-38-20	38	M52x2	-38	1-1/4	-20	4.96	126	1.30	33	60	1.89	48

+ Non-standard