

43 Series Fittings

Use with 301, 301LT, 304, 341, 381, 421, 421HT, 421WC, 424, 431, 436, 451TC, 471, 471ST, 481, 601, 604, and 881 hoses.

19243 Female BSP Parallel Pipe - Swivel Straight (60° Cone)

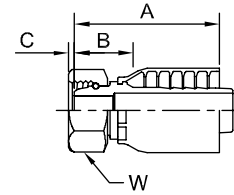

Note: When measuring overall length to the end of the nut, B & C must be used to calculate cut-off allowance.

# Part Number	Thread		Hose		A		C		W	B	
	inch		inch		inch	mm	inch	mm	mm	inch	mm
19243-4-4	1/4x19	-4	1/4	-4	1.65	42	0.22	6	19	0.92	19
19243-6-6	3/8x19	-6	3/8	-6	2.17	49	0.26	7	22	1.16	20
19243-8-8	1/2x14	-8	1/2	-8	2.28	58	0.28	7	27	1.03	24
19243-10-8	5/8x14	-10	1/2	-8	2.17	55	0.37	9	30	0.92	20
19243-10-10	5/8x14	-10	5/8	-10	2.36	60	0.37	9	30	0.95	21
19243-12-10	3/4x14	-12	5/8	-10	2.64	67	0.35	9	32	0.94	24
19243-12-12	3/4x14	-12	3/4	-12	2.52	64	0.35	9	32	1.09	28
19243-16-16	1x11	-16	1	-16	2.99	76	0.44	11	41	1.40	36
19243-20-16+	1-1/4x11	-20	1	-16	3.82	97	0.41	10	50	2.20	56
19243-24-24+	1-1/2x11	-24	1-1/2	-24	4.64	118	0.53	13	60	2.95	75

1B143 Female BSP Parallel Pipe - Swivel 45° Elbow (60° Cone)

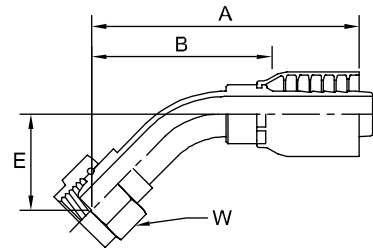

# Part Number	Thread		Hose		A		E		W	B	
	inch		inch		inch	mm	inch	mm	mm	inch	mm
1B143-4-4	1/4x19	-4	1/4	-4	2.44	62	0.63	16	19	1.54	39
1B143-6-4+	3/8x19	-6	1/4	-4	2.69	68	1.00	25	19	1.94	49
1B143-6-6	3/8x19	-6	3/8	-6	3.25	83	0.79	20	22	2.25	57
1B143-8-8	1/2x14	-8	1/2	-8	3.35	85	0.79	20	27	1.97	50
1B143-10-10	5/8x14	-10	5/8	-10	4.03	102	0.85	22	30	2.62	67
1B143-12-10	3/4x14	-12	5/8	-10	4.09	104	1.14	29	32	2.52	64
1B143-12-12	3/4x14	-12	3/4	-12	4.02	102	1.14	29	32	2.44	62
1B143-16-16	1x11	-16	1	-16	4.53	115	1.14	29	41	2.76	70

+ Non-standard