

43 Series Fittings

Inverted SAE

Use with 301, 301LT, 304, 341, 381, 421, 421HT, 421WC, 424, 431, 436, 451TC, 471, 471ST, 481, 601, 604, and 881 hoses.

16743 Male Inverted SAE 45° - Swivel 45° Elbow

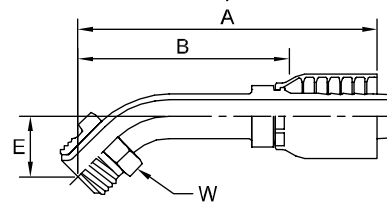

# Part Number	Thread			Hose		A		E		W	B	
	inch			inch		inch	mm	inch	mm	inch	inch	mm
	inch	mm	Length	inch	Length							
16743-4-4	1/4	7/16x24	-4	1/4	-4	2.10	53	0.63	16	7/16	1.35	34
16743-4-6	1/4	7/16x24	-4	3/8	-6	2.44	62	0.62	16	7/16	1.39	35
16743-5-4	5/16	1/2x20	-5	1/4	-4	2.35	60	0.70	18	1/2	1.60	41
16743-5-6	5/16	1/2x20	-5	3/8	-6	2.39	61	0.70	18	1/2	1.38	35
16743-6-4+	3/8	5/8x18	-6	1/4	-4	2.80	70	0.94	24	5/8	2.05	52
16743-6-6	3/8	5/8x18	-6	3/8	-6	2.90	74	0.94	24	5/8	1.90	48
16743-7-6+	7/16	11/16x18	-7	3/8	-6	3.01	76	1.02	26	11/16	1.98	50
16743-8-8	1/2	3/4x18	-8	1/2	-8	3.22	82	1.09	28	3/4	1.97	50

16943 Male Inverted SAE 45° - Swivel 90° Elbow

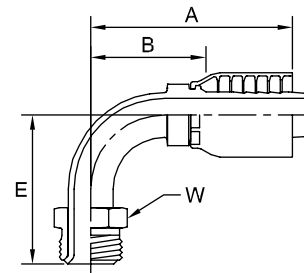

# Part Number	Thread			Hose		A		E		W	B	
	inch			inch		inch	mm	inch	mm	inch	inch	mm
	inch	mm	Length	inch	Length							
16943-3-4+	3/16	3/8x24	-3	1/4	-4	1.96	50	1.20	30	3/8	1.21	31
16943-4-4	1/4	7/16x24	-4	1/4	-4	2.17	55	1.56	40	7/16	1.42	36
16943-4-6	1/4	7/16x24	-4	3/8	-6	2.49	63	1.56	40	7/16	1.49	38
16943-5-4	5/16	1/2x20	-5	1/4	-4	2.42	61	1.62	41	1/2	1.67	42
16943-5-6	5/16	1/2x20	-5	3/8	-6	2.59	66	1.65	42	1/2	1.55	39
16943-6-6	3/8	5/8x18	-6	3/8	-6	2.59	66	1.69	43	5/8	1.59	40
16943-6-8+	3/8	5/8x18	-6	1/2	-8	2.81	71	1.69	43	5/8	1.59	40
16943-7-6	7/16	11/16x18	-7	3/8	-6	2.52	64	1.72	44	11/16	1.52	39
16943-8-8	1/2	3/4x18	-8	1/2	-8	2.83	72	1.88	48	3/4	1.48	38
16943-12-12+	3/4	1-1/16x16	-12	3/4	-12	3.60	91	2.51	64	1-1/16	2.16	55

+ Non-standard