

### 43 Series Fittings

Use with 301, 301LT, 304, 341, 381, 421, 421HT, 421WC, 424, 431, 436, 451TC, 471, 471ST, 481, 601, 604, and 881 hoses.

## 13943 Female JIC 37° - Swivel 90° Elbow - Short Drop

Note: More sizes of this fitting are located on the previous page.

# Part Number	Thread			Hose		A		E		W	B	
	inch			inch		inch	mm	inch	mm	inch	inch	mm
	13943-16-12	1	1-5/16x12	-16	3/4	-12	3.47	88	2.00	51	1-1/2	2.05
13943-16-16	1	1-5/16x12	-16	1	-16	4.05	103	2.14	54	1-1/2	2.46	62
13943-16-16C+	1	1-5/16x12	-16	1	-16	4.32	110	2.43	62	1-1/2	2.70	69
13943-20-16+	1-1/4	1-5/8x12	-20	1	-16	1.00	25	2.44	62	2	2.28	58
13943-20-20	1-1/4	1-5/8x12	-20	1-1/4	-20	4.38	111	2.59	66	2	2.73	69
13943-24-24+	1-1/2	1-7/8x12	-24	1-1/2	-24	5.46	139	3.18	81	2-1/4	4.17	106
13943-32-32+	2	2-1/2x12	-32	2	-32	6.50	165	4.61	117	2-7/8	4.97	126

## 1L943 Female JIC 37° - Swivel 90° Elbow - Medium Drop

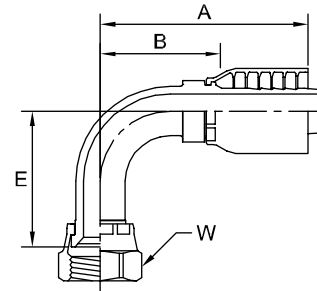

~ These 1L943 fittings contain a dual seat that accepts both the JIC (37°) and SAE (45°) male configurations. The other sizes accept the JIC (37°) male configurations only.

# Part Number	Thread			Hose		A		E		W	B	
	inch			inch		inch	mm	inch	mm	inch	inch	mm
	1L943-4-4~	1/4	7/16x20	-4	1/4	-4	1.85	47	1.26	32	9/16	1.10
1L943-6-4+	3/8	9/16x18	-6	1/4	-4	2.13	54	1.12	28	11/16	1.38	35
1L943-6-6	3/8	9/16x18	-6	3/8	-6	2.28	58	1.12	28	11/16	1.28	33
1L943-8-6~	1/2	3/4x16	-8	3/8	-6	2.50	64	1.38	35	7/8	1.50	38
1L943-8-8~	1/2	3/4x16	-8	1/2	-8	2.65	67	1.38	35	7/8	1.40	36
1L943-10-8~	5/8	7/8x14	-10	1/2	-8	3.25	83	1.75	44	1	2.00	51
1L943-12-12	3/4	1-1/16x12	-12	3/4	-12	3.50	89	2.28	58	1-1/4	2.22	56
1L943-16-16	1	1-5/16x12	-16	1	-16	4.42	112	2.50	64	1-1/2	2.83	72

+ Non-standard