

### 43 Series Fittings

Use with 301, 301LT, 304, 341, 381, 421, 421HT, 421WC, 424, 431, 436, 451TC, 471, 471ST, 481, 601, 604, and 881 hoses.

## 1L743 Female JIC 37° - Swivel 45° Elbow - Medium Drop

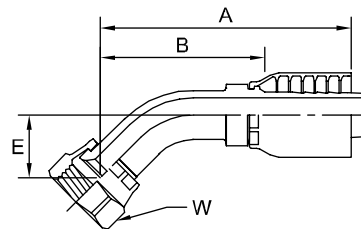

~ These 1L743 fittings contain a dual seat that accepts both the JIC (37°) and SAE (45°) male configurations. The other sizes accept the JIC (37°) male configurations only.

# Part Number	Thread			Hose		A		E		W	B	
	inch			inch		inch	mm	inch	mm	inch	inch	mm
1L743-6-6	3/8	9/16x18	-6	3/8	-6	2.66	62	0.59	15	11/16	1.66	37
1L743-8-8~	1/2	3/4x16	-8	1/2	-8	3.18	81	0.72	19	7/8	1.93	49
1L743-12-12	3/4	1-1/16x12	-12	3/4	-12	4.23	105	1.06	27	1-1/4	2.71	69
1L743-16-16	1	1-5/16x12	-16	1	-16	4.52	115	1.10	28	1-1/2	2.93	74

## 13943 Female JIC 37° - Swivel 90° Elbow - Short Drop

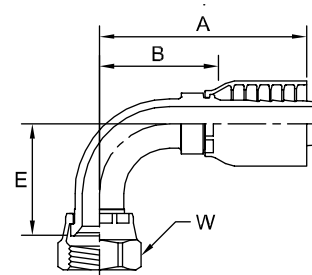

~ These 13943 fittings contain a dual seat that accepts both the JIC (37°) and SAE (45°) male configurations. The other sizes accept the JIC (37°) male configurations only.

Note: "C" - Stainless Steel Fitting. Must be crimped with Karrykrimp 2, PHastkrimp, Superkrimp, or Parkrimp 2.

# Part Number	Thread			Hose		A		E		W	B	
	inch			inch		inch	mm	inch	mm	inch	inch	mm
13943-4-4~	1/4	7/16x20	-4	1/4	-4	1.79	45	0.83	21	9/16	1.04	26
13943-4-4C~+	1/4	7/16x20	-4	1/4	-4	1.78	45	0.83	21	9/16	1.03	26
13943-4-6~	1/4	7/16x20	-4	3/8	-6	2.11	54	0.83	21	9/16	1.08	27
13943-5-4~	5/16	1/2x20	-5	1/4	-4	2.18	55	0.83	21	5/8	1.43	36
13943-5-5~	5/16	1/2x20	-5	5/16	-5	2.27	58	0.83	21	5/8	1.52	39
13943-5-6~+	5/16	1/2x20	-5	3/8	-6	2.28	58	0.77	20	5/8	1.28	33
13943-6-4	3/8	9/16x18	-6	1/4	-4	2.13	54	0.85	22	11/16	1.38	35
13943-6-5+	3/8	9/16x18	-6	5/16	-5	2.22	56	0.85	22	11/16	1.47	37
13943-6-6	3/8	9/16x18	-6	3/8	-6	2.28	58	0.85	22	11/16	1.28	33
13943-6-6C+	3/8	9/16x18	-6	3/8	-6	2.28	58	0.85	22	11/16	1.28	33
13943-6-8	3/8	9/16x18	-6	1/2	-8	2.52	64	0.85	22	11/16	1.27	32
13943-8-6~	1/2	3/4x16	-8	3/8	-6	2.50	64	1.09	28	7/8	1.50	38
13943-8-6C~+	1/2	3/4x16	-8	3/8	-6	2.50	64	1.09	28	7/8	1.50	38
13943-8-8~	1/2	3/4x16	-8	1/2	-8	2.65	67	1.09	28	7/8	1.40	36
13943-10-8~	5/8	7/8x14	-10	1/2	-8	2.78	71	1.26	32	1	1.52	39
13943-10-10~	5/8	7/8x14	-10	5/8	-10	3.09	78	1.24	31	1	1.58	40
13943-10-12~+	5/8	7/8x14	-10	3/4	-12	3.10	79	1.24	31	1	1.66	42
13943-12-8	3/4	1-1/16x12	-12	1/2	-8	3.17	81	1.81	46	1-1/4	1.92	49
13943-12-10	3/4	1-1/16x12	-12	5/8	-10	3.49	89	1.89	48	1-1/4	2.05	52
13943-12-12	3/4	1-1/16x12	-12	3/4	-12	3.51	89	1.81	46	1-1/4	2.07	53
13943-12-12C+	3/4	1-1/16x12	-12	3/4	-12	3.51	89	1.81	46	1-1/4	2.07	53

Note: More sizes of this fitting are located on the following page.

+ Non-standard